



# PASCHIM BANGA GRAMIN BANK

## Regional Office, Howrah.

58/1 Ashim Roy Sarani(Kantapukur 3<sup>rd</sup> Bye Lane)  
P.O. Kadamtala , P.S. Bantra, Howrah, WB - 711101

Date- 21.09.2023

### Tender Notice

Sir/Madam,

Paschim Banga Gramin Bank, Regional Office - Howrah invites application Cum Sealed Quotations from authorized experience interior vendors for the interior furniture work as per schedule(B.O.Q) & layout (enclosed) at Bhatara Branch-New Premises . Intending suppliers are requested to submit the quotation in sealed envelope at R.O HOWRAH as per below mentioned notice.

| Sl. No. | Description – 1   | Description – 2  |
|---------|---|--|
| 1.      | Name & Location of Work   | Interior Furniture work at 1st Floor of Paschim Banga Gramin Bank- Bhatara branch – New Premises . vill : kulia , howrah – 711303 .  |
| 2.      | Time allowed for completion   | 7 days including Sundays and holidays  |
| 3.      | Last date and time of submission of tender  | 3 PM on or before – 28.09.2023   |
| 4.      | Queries   | On or before 28.09.2023 in between 3.00pm to 4.00 pm on each day. Contact person : Mr.Arnab Mukherjee,OMM-II,AGA; Mob:9804923106.<br>e-mail:"howrahro.acct" <howrahro.acct@pbgb.co.in>;  |
| 5.      | Date & Time of opening of sealed bid  | 3.30 PM on 28.09.2023  |
| 6.      | Address of available, submission & Submission of Tender Document.                           | Senior Manager, AGA<br>Paschim Banga Gramin Bank – Regional Office<br>58/1 Ashim Roy Sarani(Kantapukur 3 <sup>rd</sup> Bye Lane)<br>P.O. Kadamtala , P.S. Bantra, Howrah, WB - 711101  |
| 7.      | Earnest Money Deposit (EMD)   | 2 % of the estimate value to be deposited in form of Demand Draft at the office of PBGB, Howrah in favour of ( Paschim Banga Gramin Bank ) payable at Howrah, under sealed envelope.   |
| 8.      | Defective liability period  | 12 months from the date of virtual completion of work  |
| 9.      | Validity of offer   | 3 months from the date of opening of price bid   |
| 10.     | Security Deposit:   | 5% on the estimated Rate   |
| 11.     | Liquated damages  | 0.5% per week subject to a maximum of 5% of contract value.  |
| 12.     | Approximate Estimated cost of the project.  | Quoted Rate + GST as applicable  |
| 13.     | Documents Required to be submitted with Quotation at Paschim Bangla Gramin Bank Head Office | <b>ENVELOP-1(TECHNICAL BID)</b><br>1. scanned copy of valid trade licence & P-Tax.<br>2. scanned copy of pan.<br>3.scanned copy of ITR for the financial year 2019-2020 ,2020-2021, 2021-2022 & 2022-2023<br>4.GST registration no:- return of (GSTR-1/GSTR-3) for 2021-2022 & 2022-2023.<br><br><b>ENVELOP - 2(COMMERCIAL BID/PRICE BID)</b><br><br>ENVELOP - 1 & ENVELOP - 2 -COMBINED IN BIG ENVELOP. |

PBGB-ROH Has The Right To Accept /Reject any/All Quotation(S) Without Assigning Any Reason.

  
Regional Manager

**Tender Schedule for Bhatara br. New premises as per layout**

| Sl.no | Particulars  | Qty        | Rate (Rs.) |
|-------|--|------------|------------|
| 1     | New counter with key board, C.P.U etc keeping arrangement. Cash cage counter one side two drawer, counter height 3'-9", counter top 1'-3" and lower table height 2'-6" x deep 2'-9". Counters made by 19 mm ply. Counter top table, cupboard, drawer, and shutter and counter front laminate pasting. Cupboard, drawer inside painting.  | 19 Rft     |            |
| 2     | Front partition of the cash cage will be covered by 12 mm glass of size 5'-0"x3'-3" in each cash cage and there will be cutting out of 6"x4" half round for transaction of the counter and 2" split for conversation and upper portion will be blocked by 12mm glass.  | 48.75 Sft  |            |
| 3     | Cash cage side and back partition made of 2"x2" & 2"x1" wooden frame work made of kappor/ sal wood. 7'-0" h.t partition, out of which 45" height will be covered by 6mm BWR ply on both side with laminate pasting; upper portion will be covered by 6mm glass. There will be an internal transaction hole of 2"x10". Glasses will be fixed with c.p teak wood bead with polishing finish. | 208 Sft    |            |
| 4     | Supplying and fixing flush door for cash cage and officer. Door made of 30mm flush door, lower portion up to 45" both side laminate pasting and rest portion 6 mm glass fitting with c.p teak wood bead with polishing. Door fitting with hinge, door closer, lock, door stopper etc.  | 50.625 Sft |            |
| 5     | Both room front 7'-0" h.t partition making. Partition made by 2"x1½" wooden frame, both side 6mm ply fitting. Partition front side laminate pasting and inside painting finish.  | 49 sft     |            |
| 6     | Counter entrance two shutter door.   | 14 Sft     |            |
| 7     | Cash cage side partition made by 2"x1½" wooden frame, both side 6mm ply fitting with laminate pasting.   | 28 Sft     |            |
| 8     | Cash cage side door made by 30 mm flush door. Door lower portion up to 45" both side laminate pasting and rest portion 6 mm glass fitting with c.p teak wood bead with polishing. Door fitting with hinge, door closer, lock, door stopper etc.  | 21 Sft     |            |
| 9     | Main door two shutter with frame for A.C. Frame made by 3"x1½" wood with painting. Shutter made by 30mm flush door up to 4'-0" both side laminate pasting and rest portion 6 mm glass fitting with wooden bead. Shutter fitting with hinge, locking arrangement and door closer.   | 35 sft     |            |

For PASCHIM BANGA GRAMIN BANK

  
 Regional Manager  
 Regional Office (Howrah)

|                           |   |       |  |
|---------------------------|---|-------|--|
| 10                        | 5'-0"x3'-0"x2'-6" Manager table made by 19 mm ply with laminate pasting. Table one side 3 drawer and provision for keyboard. Table top 6mm glass. | 1ps   |  |
| 11                        | 4'-0"x2'-6"x2'-6" Officer table made by 19 mm ply with laminate pasting. Table one side 3 drawer with keyboard tray. Table top 6mm glass.         | 1ps   |  |
| 12                        | Manager's chair (High back) with revolving.   | 1ps   |  |
| 13                        | Officer's chair (mid back) with revolving.  | 1ps   |  |
| 14                        | Wooden chair with handle for counter, made by c.p teak wood, only seat 12mm B.W.P ply with polishing.   | 4pcs  |  |
| 15                        | Without handle wooden chair for manager and officer visitor, made by c.p teak wood, only seat 12mm B.W.P ply with polishing.                      | 4pcs  |  |
| 16                        | Iron rack 6'-0"x4'-0"x1'-6" with six shelf.   | 3pcs  |  |
| 17                        | Customer's bench-cum-chair 6'-0"x1'-6" with sheet & back perforated with handle (steel finish).   | 3 pcs |  |
| 13                        | Steel Amirah as per Bank standard size.   | 4ps   |  |
| <b>Grand Total in Rs.</b> |   |       |  |

### Materials Specification

- 1) Block Board and Ply = Globe, Raffel, Mayur, Muskan.
- 2) Laminate 1mm = Green/ Marino.
- 3) Wood = Kapoor / Red sal/Gammar.
- 4) Lock = Godraj make (mortice lock).
- 5) Glass = Saint Gobain/Modiguard.

For PASCHIM BANGA GRAMIN BANK

  
Regional Manager  
Regional Office (Howrah)

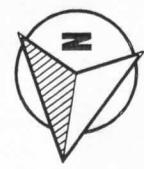
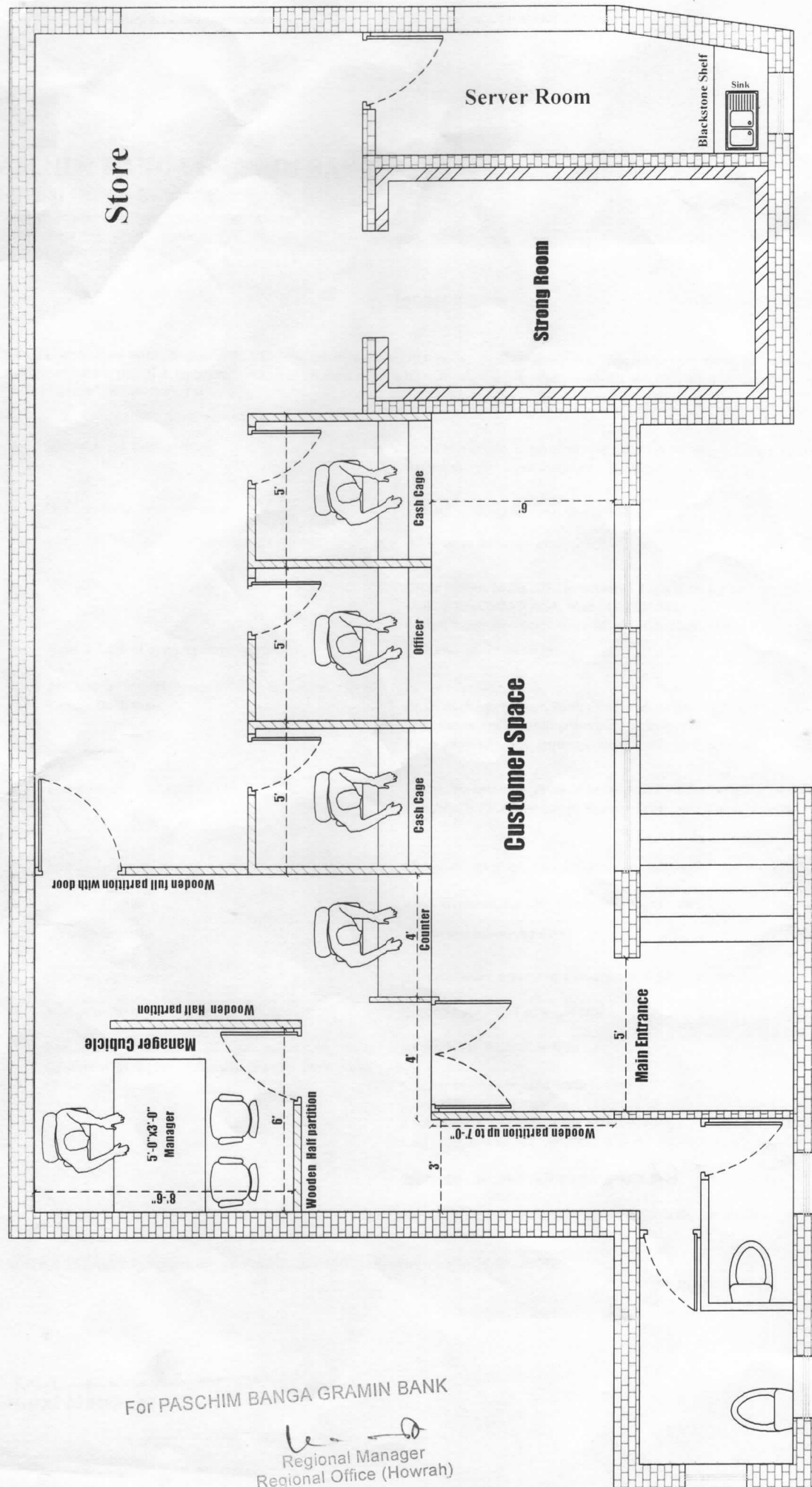

Proposed Floor Plan With Counter Layout  
for P.B.G.B Bhatora Br at First Floor.

For PASCHIM BANGA GRAMIN BANK

*[Signature]*  
Regional Manager  
Regional Office (Howrah)